

xiaomi

Electric Shaver S101 User Manual



Safety Instructions

WARNINGS

- Keep the appliance dry.
- Detach the hand-held part from the supply cord before cleaning it in water.
- This appliance is not intended for use by persons (including children) with reduced physical, sensory or mental capabilities, or lack of experience and knowledge, unless they have been given supervision or instruction concerning use of the appliance by a person responsible for their safety.
- Children should be supervised to ensure that they do not play with the appliance.
- Use only with <A520-050100U-EU1> supply unit.
- This appliance contains batteries that are non-replaceable.
- For the purposes of recharging the battery, only use the detachable supply unit provided with this appliance.
- The plug must be removed from the socket-outlet before cleaning or maintaining the appliance.
- Appliance can be used by children aged from 8 years and above and persons with reduced physical, sensory or mental capabilities or lack of experience and knowledge if they have been given supervision or instruction concerning use of the appliance in a safe way and understand the hazards involved.

CAUTIONS

- Cleaning and user maintenance shall not be made by children without supervision.
- Do not charge this shaver in humid environments.
- Do not disassemble the body to replace the battery.
- Do not modify or repair this shaver yourself.
- The appliance is not suitable for use in a bath or shower.
- Do not expose the appliance or battery to excessive temperatures. Be aware of the risk of terminals of the battery-operated appliance or battery being short circuited by metal objects.



Suitable for cleaning
under an open water tap

Product Overview

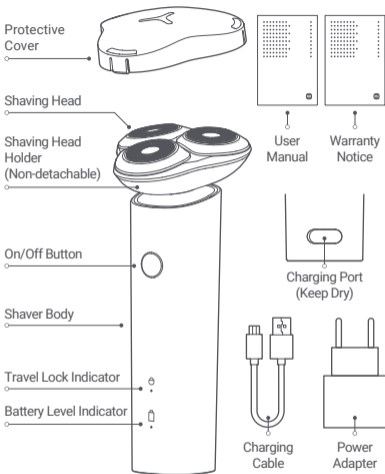

Note: Illustrations of product, accessories, and user interface in the user manual are for reference purposes only. Actual product and functions may vary due to product enhancements.

How to Use

- It is recommended to clean the shaving head before first use. It is normal for the skin to be slightly irritated after the first few shaves. It is recommended to regularly use the shaver (at least 3 times a week) for 3 weeks to allow the skin to adapt as quickly as possible.
- Press the on/off button to turn on/off the shaver.
- Apply gentle pressure while shaving your face slowly in circular motions.



Note:

- Do not pull the shaving head holder as it is non-detachable.



Notes:

- Improper use of this shaver can easily cause damage to the shaving head. Please check whether the shaving head is intact before use. Immediately stop using the shaving head if any damage is found.
- Shave dry for optimal result. When shaving the hard-to-shave areas such as the chin and neck, it is recommended to move the shaver against the direction of the beard growth.

Battery Level Indication

Plug the charging cable into the charging port and connect it to a power outlet to start charging. Description of the battery level indicator status is as below:

Battery Level While Charging	Indicator Status
0%–40%	Blinking orange
40%–100%	Blinking white
100%	Keeping white

Battery Level While Working	Indicator Status
40%–100%	Keeping white
20%–40%	Keeping orange
10%–20%	Blinking orange
<10%	Quickly blinking orange three times (unable to turn on)

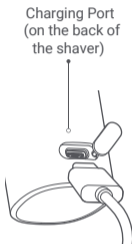

Note: The shaver supports Pass Through Charging. When the battery is low, you can use the shaver during charging.

CAUTION: Never plug in or use the shaver in the shower or when the charging port is wet.

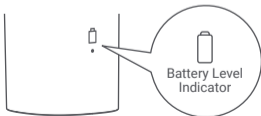

When the shaver cannot be turned on due to a low battery, it will take about 90 minutes to fully charge it. The shaver can be used for about 60 minutes after a full charge. Please charge the shaver when its battery is low. Fully charge the shaver at least once every 6 months if it will not be used for an extended period of time.

Travel Lock

This shaver is equipped with a travel lock to prevent it from accidentally being turned on while it is inside the luggage.

- Enabling the travel lock: When the shaver is turned off, press and hold the on/off button for 2.5 seconds until the motor stops to enable the travel lock. Once it is enabled, the travel lock indicator will keep on for 3 seconds and then go off.
- Disabling the travel lock: Press and hold the on/off button for 2.5 seconds until the motor runs to disable the travel lock.

Note: When the travel lock is enabled, if you press the on/off button, the travel lock indicator will blink.

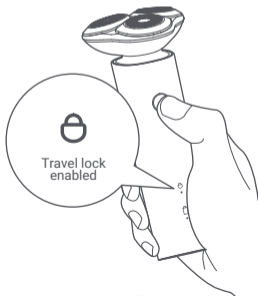

Care & Maintenance

To ensure optimal functionality, please clean the shaver after each use.

1. Make sure the shaver is turned off and is not being charged before cleaning it.



2. Rinse the shaving head under a faucet.



3. Pull the shaving head and remove it from the holder.



4. Rinse or use the cleaning brush to clean the shaving head holder.



5. Turn the shaving head upside-down and clean the inside under a faucet (do not use a towel or paper towel to clean the shaving head).

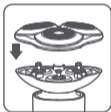

6. Thoroughly dry off the shaver, then install the shaving head back onto the holder.



Note: Use the protective cover to cover the charging port while cleaning the shaver. Make sure the charging port is dry when plugging in the cable to charge.



Note: The shaver can be cleaned under a faucet (to keep the charging port dry, make sure it is firmly covered).

To ensure the performance of the shaver, it is recommended to replace the shaving head every half a year. Please go to www.mi.com to purchase a replacement.

Environmental Protection

When the shaver reaches the end of its service life, please remove, dispose of, or recycle the built-in battery in accordance with local laws and regulations of the country or region where the shaver is used. If the battery cannot be removed, dispose of it in strict accordance with local regulations on household waste management in your area.

WARNINGS:

- This shaver contains a non-replaceable battery.
- Do not expose the battery to fire to prevent it from exploding or releasing toxic and hazardous substances.
- Do not short-circuit the battery to prevent it from combusting and causing fire.
- Do not disassemble the shaver unless you want to dispose of it; otherwise, the shaver will be damaged.
- Make sure to operate in a safe manner and unplug the shaver before removing the battery.
- The battery must be removed from the appliance before it is scrapped.
- The appliance must be disconnected from the supply mains when removing the battery.
- The battery is to be disposed of safely.

Troubleshooting

Issues	Possible Causes	Solutions
Poor-quality shaving	The shaving head (including blade mesh) is damaged or worn out.	Replace with a genuine shaving head.
	The shaving head is clogged up with stubbles.	Thoroughly clean the shaving head.
Shaver not working after pressing the on/off button	The travel lock is enabled.	Press and hold the on/off button for 2.5 seconds to unlock.
	The battery is depleted.	Connect the charging cable to charge.
	The on/off button does not function.	Contact the after-sales service team.
Irritated skin after shaving	It takes a certain period of time for your skin to adapt to the shaver.	Skin irritation will fade after 2–3 weeks of use.
Charging error	The charging port contact is poor.	Reconnect the charging cable.
	The charger may be damaged.	Replace the charger.
	The charging ambient temperature is too low or too high.	Charge in an ambient temperature between 5°C and 35°C.
	The shaver is damaged.	Contact the after-sales service team.

Usage time less than 60 minutes after being fully charged	The load on the motor is increased as the shaving head hasn't been cleaned for a long time.	Thoroughly clean the shaving head.
	It may be caused by the shaving method and beard density.	Shave in a normal way.

Specifications

Name: Xiaomi Electric Shaver S101

Model: S101

Operating Voltage/Power: 3.7 V_{DC} /3 W

Input: 5 V_{DC} 1 A

IP Rating: IPX7

Charging Port: Type-C

Charging Time: Approx. 90 min

Power Adapter

Input: 100–240
V~, 50/60 Hz, 0.2

Output: 5.0 V  1.0 A,
5.0 W

Information Published	Value and Precision	Unit
Manufacturer's Name	Jiangxi Jian Aohai Technology Co., Ltd.	—
Model Identifier	A520-050100U-EU1	—
Input Voltage	100–240	V~
Input AC Frequency	50/60	Hz
Output Voltage	5.0	V 
Output Current	1.0	A
Output Power	5.0	W
Average Active Efficiency	73.77	%
Efficiency at Low Load (10%)	64.588	%
No-load Power Consumption	0.075	W

A520-050100U-EU1



Use only with <A520-050100U-EU1>
supply unit.



Read operator's manual.



Europe-EU Declaration of Conformity

We, Shenzhen Soocas Technology Co., Ltd., hereby, declares that this equipment is in compliance with the applicable Directives and European Norms, and amendments. The full text of the EU declaration of conformity is available at the following internet address:

<http://www.mi.com/global/service/support/declaration.html>



WEEE Disposal and Recycling Information

All products bearing this symbol are waste electrical and electronic equipment (WEEE as in directive 2012/19/EU) which should not be mixed with unsorted household waste. Instead, you should protect human health and the environment by handing over your waste equipment to a designated collection point for the recycling of waste electrical and electronic equipment, appointed by the government or local authorities. Correct disposal and recycling will help prevent potential negative consequences to the environment and human health. Please contact the installer or local authorities for more information about the location as well as terms and conditions of such collection points.

Manufactured for: Xiaomi Communications Co., Ltd.
Manufactured by: Shenzhen Soocas Technology Co., Ltd.
(a Mi Ecosystem company)

Address: Room 401, 402, 1101, 1102, 1103, 1104, Building 2
Chongwen Area, Nanshan iPark, No. 3370 Liuxian Avenue,
Fuguang Community, Taoyuan Subdistrict, Nanshan District,
Shenzhen, China

For further information, please go to www.mi.com

Made in China

User Manual Version: V1.0

Importer:
Beryko s.r.o.
Pod Vinicí 931/2, 301 00 Plzeň
www.beryko.cz